



CHARTWELL MARINE

Archipelago 40

REFINING THE FORMULA FOR ADVENTURE



FEATURES

BUILT FOR PURPOSE

The Archipelago 40 exploration catamaran is a true multifunction vessel, engineered to meet the demining standards of a workboat with the option for a high end fit out to provide a seaworthy platform suitable for long range cruising, silent running, dive support, photography/videography and more.

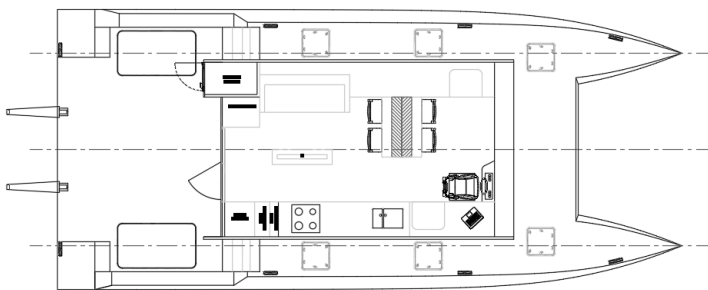
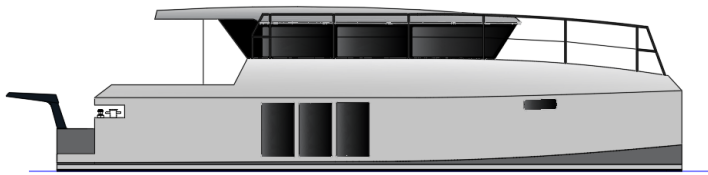

ARCHIPELAGO 40

LOA 12.5m

BOA 5.6m

Engine 2 X 250Hp Yanmar 4LV

Hybrid 2 X 100kW El Motor + 39.1 kW Battery Bank

Propulsion Twin Fixed Pitch Propellor

Speed 21kts

MCA (Yellow Code), RCD Category A

ABOUT

CHARTWELL MARINE

Chartwell Marine is a pioneer in next-generation vessel design. A reputed naval architect with an industry-leading track record designing award-winning high-speed vessels, Chartwell Marine supports ambitious boat builders and vessel operators around the world with specialist, independent design and consultancy services.

CONTACT US

To find out more about Chartwell Marine, please visit:

<http://www.chartwellmarine.com>

